



15,500 lb Capacity Diesel Pneumatic Tire Forklift Truck



The FD70E is designed to tackle many tough jobs with ease. In an effort to minimize operator fatigue, these trucks are equipped with an operator compartment that promotes comfort and productivity. The specially designed operator's seat incorporates cushion bolsters for leg and lumbar support, while the comfort-stretch seat belt provides the necessary freedom to move from side to side when engaging in reverse travel. All trucks offer an easy-to-read instrument panel that is ergonomically mounted to the steering column.



Specifications

CHARACTERISTICS			FD70E				
1	Capacity	at rated load center	lb	kg	15,500	7,000	
2		at load center – distance	in	mm	24	610	
3	Power	diesel, gas, LP gas	diesel				
4	Tire type	cushion, pneumatic	pneumatic				
5	Wheels (x = driven)	number front / rear	x4 / 2				
DIMENSIONS							
10	Lift	maximum fork height with rated load	in	mm	197	5,000	
11	Lift with standard two-stage mast	maximum fork height	in	mm	148	3,700	
12		free fork height	in	mm	7.9	200	
13	Forks	thickness x length x width	in	mm	2.4 x 48 x 5.9	60 x 1,220 x 150	
	Fork spacing	out-to-out minimum / maximum	in	mm	15.4 / 65.5	390 / 1,670	
14	Tilt	forward / backward	deg		6° / 12°		
15	Overall dimensions	length to fork face	in	mm	143.3	3,635	
16		width	standard dual drive tires	in	mm	85.6	2,175
			optional dual drive tires	in	mm	N/A	
17		height	with lowered mast	in	mm	115	2,920
18			seat height	in	mm	53	1,350
19			to top of overhead guard	in	mm	95.3	2,420
20	with extended mast		in	mm	196.1	4,980	
21	Minimum outside turning radius		in	mm	133.7	3,395	
22	Load moment constant		in	mm	23	585	
23	Minimum aisle – 90° stack – zero clearance w/out load		in	mm	156.7	3,980	
PERFORMANCE							
40	Speeds	travel speed loaded / empty	mph	km/h	13.7 / 17.1	22.0 / 27.5	
41		lift speed loaded / empty	fpm	m/s	86 / 92	0.44 / 0.47	
42		lowering speed loaded / empty	fpm	m/s	108 / 108	0.55 / 0.55	
43	Draw bar pull	loaded at 1 mph (1.6 km)	lb	N	9,599	42,700	
		loaded maximum	lb	N	12,589	56,000	
44	Gradeability	loaded at 1 mph (1.6 km)	%		27		
		maximum loaded / empty	%		37 / 27		
WEIGHT							
50	Empty		lb	kg	20,705	9,390	
51	Axle load	with rated load front / rear	lb	kg	32,520 / 3,685	14,730 / 1,660	
		without load front / rear	lb	kg	9,085 / 11,620	4,120 / 5,270	
CHASSIS							
60	Tire size	front, standard dual drive tires	in		8.25 x 15-12PR		
		front, optional dual drive tires	in		N/A		
61		rear	in		8.25 x 15-12PR		
62	Wheel base		in	mm	90.6	2,300	
63	Tread width	front, standard dual drive tires	in	mm	65.0	1,650	
		front, optional dual drive tires	in	mm	N/A		
64		rear tires	in	mm	65.0	1,650	
65	Ground clearance	at lowest point @ mast	in	mm	5.51	140	
66		at center of wheel base	in	mm	10.0	255	
67	Brakes	service	hydraulic w/vacuum boost				
68		parking	mechanical-hand				
POWERTRAIN							
80	Engine	manufacturer and model	Mitsubishi S6S-T				
81		continuous output S.A.E. gross	HP	kW	94	70	
			at r.p.m.	2,300			
82		maximum torque S.A.E. gross	lb-ft	kg-m	223	30.8	
			at r.p.m.	1,600			
83	cylinder / displacement	cu in	cm ³	6 / 305	6 / 4,996		
84	Transmission	type	automatic powershift				
85		number of speeds forward / reverse	2 / 2				
86	Relief pressure	for attachments	psi	bar	2,775	190	
87	Noise level	mean value at operator's ear	dB(A)		84.5		

NOTE: These specifications assume the use of drive axles, tires and tilt angles specified. Any modification to specifications, or any other combination of specifications made after the shipment of the truck, requires prior written approval from Mitsubishi Caterpillar Forklift America Inc. ("MCFCA"). (See ANSI/ITSDF B56.1.) Also be advised that overall operating visibility may be affected by the mast configuration and mast options of your forklift truck. Therefore, you may need to add ancillary [auxiliary] devices or modify your operating practices. Consult your dealer for further information.

Call-out numbers shown in the diagram below correspond to the first column of the specifications chart.

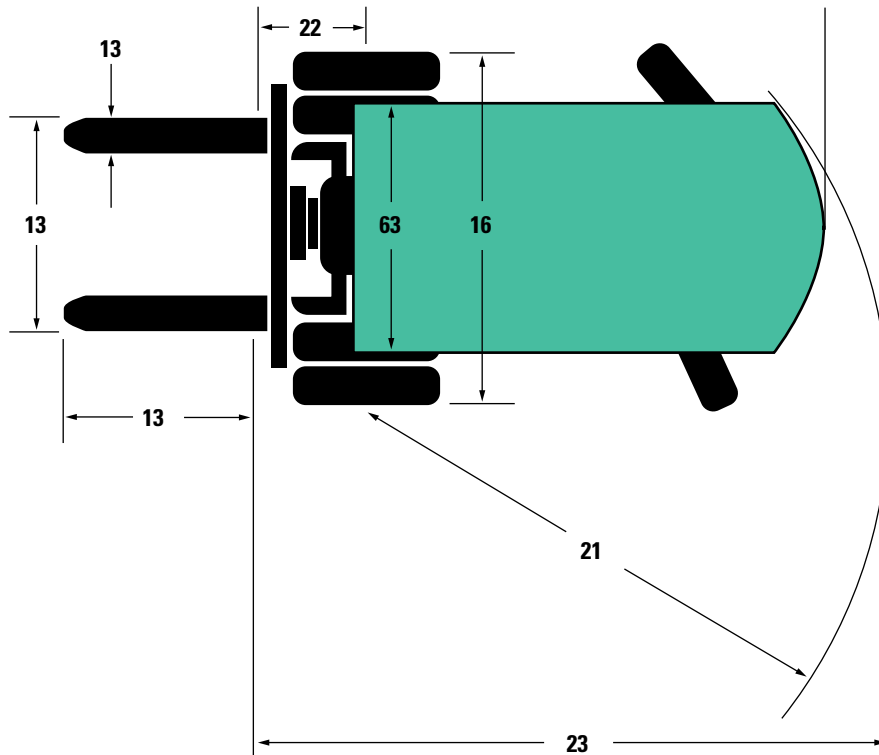
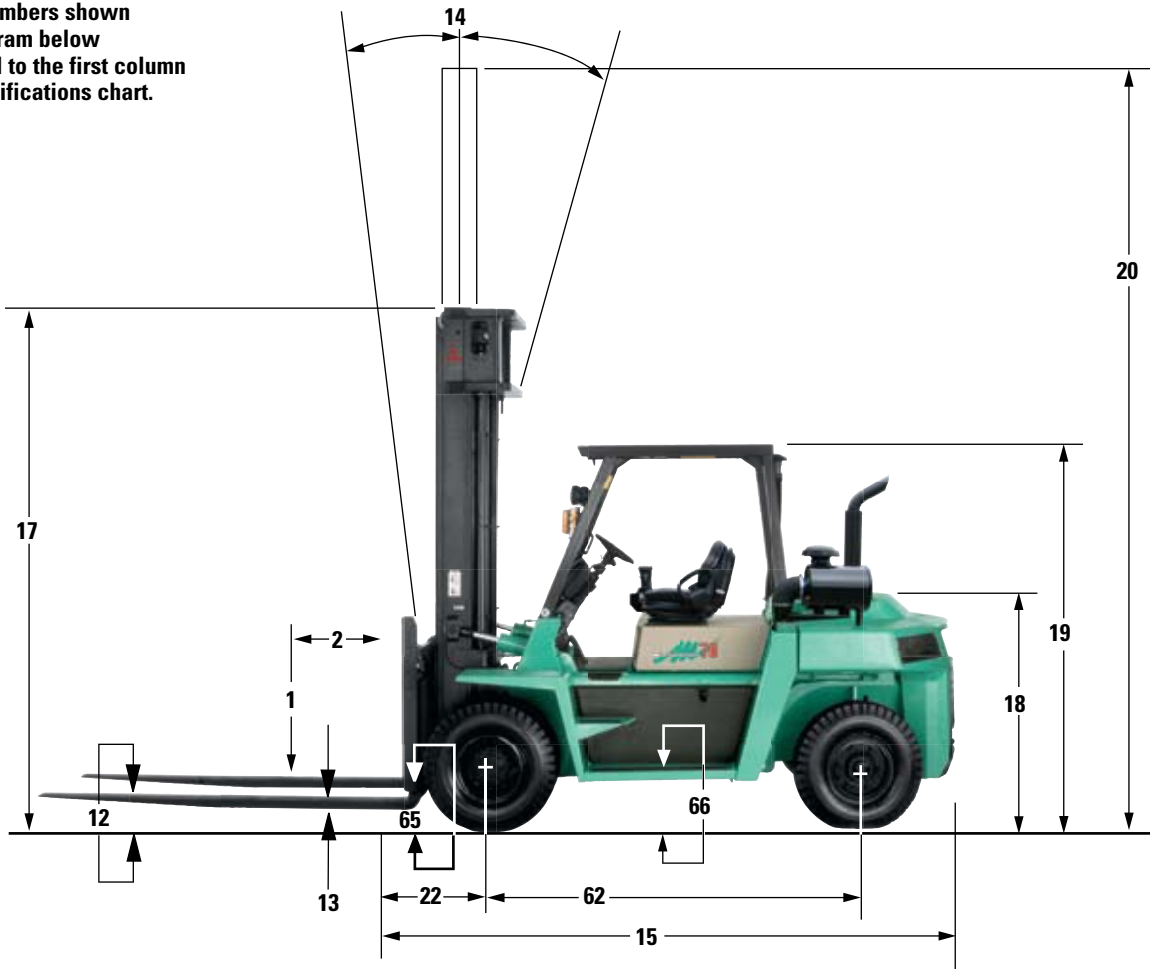



SAFETY STANDARDS

These trucks meet American National Standards Institute/ Industrial Truck Standards Development Foundation, ANSI/ITSDF B56.1. UL-Classified by Underwriters Laboratories, Inc., as to fire and electric shock hazard only; Type D, Industrial Trucks. Users should be aware of, and adhere to, applicable codes and regulations regarding operator training, use, operation and maintenance of powered industrial trucks, including:

- ANSI/ITSDF B56.1.
- NFPA 505, fire safety standard for powered industrial trucks -type designations, areas of use, maintenance and operation.
- Occupational Safety and Health Administration (OSHA) regulations that may apply.

Specifications, equipment, technical data, photos and illustrations based on information at time of printing and subject to change without notice. Some products may be shown with optional equipment.

Standard Features

- Two-speed automatic powershift transmission
- Turbo-charged In-line Mitsubishi S6S-T diesel engine – EPA emissions compliant
- 3-section valve with third lever
- Stop/tail/back-up lights
- Two headlights – OHG mounted
- Vacuum assisted power brakes
- Vertical outlet exhaust
- Full hydrostatic power steering
- Draw bar pin
- Anti-restart ignition switch
- Tilt steering column
- Electronic backup alarm
- Integrated Presence System (IPS)

Drive System

The turbo-charged S6S-T diesel engine is specifically designed for use in industrial forklift trucks. The 94-horsepower, 305 cubic inches of displacement delivers high torque, low noise and efficient fuel economy necessary to help boost travel and lift speeds while maximizing uptime. A high-performance starting system helps ensure quick starts even in temperatures to -4°F. Durability is derived from deep-skirted, cast-iron cylinder block and inline, plunger-type fuel-injection pumps.

Durability

From design to production these trucks were built with quality in mind. The high-strength masts include specially designed rollers to help absorb lateral and longitudinal forces while the parking brake features a separate shoe assembly on the drive axle. For efficient cooling the FD70E is equipped with a seven-blade suction fan mounted behind the radiator and a large-capacity cooling system that helps protect the engine components against the high temperatures often associated with sustained operations that are typical in the toughest applications.

Operator Comfort

The adjustable tilt steering column allows the steering wheel to be adjusted to any position within a 12° range of movement. The hydraulic levers are conveniently located seat side, while the large accelerator, brake and inching pedals are also positioned ergonomically for increased operator comfort.

Visibility

This forklift is equipped with a mast design that promotes good visibility. The masts on the FD70E feature widely spaced channels and strategically located cross members. Strong, yet small-diameter hydraulic cylinders and leaf-type chains maximize visibility through the mast.

Serviceability

Because the entire engine compartment is quickly accessible, routine inspections and maintenance can be performed with ease. Gas-assist cylinders allow the hood to open easily for routine maintenance. No tools are needed to access major components under the hood, floor plate or covers. The air cleaner, dipsticks and brake fluid reservoir are within easy reach and a simple bolt adjusts the fan belt.

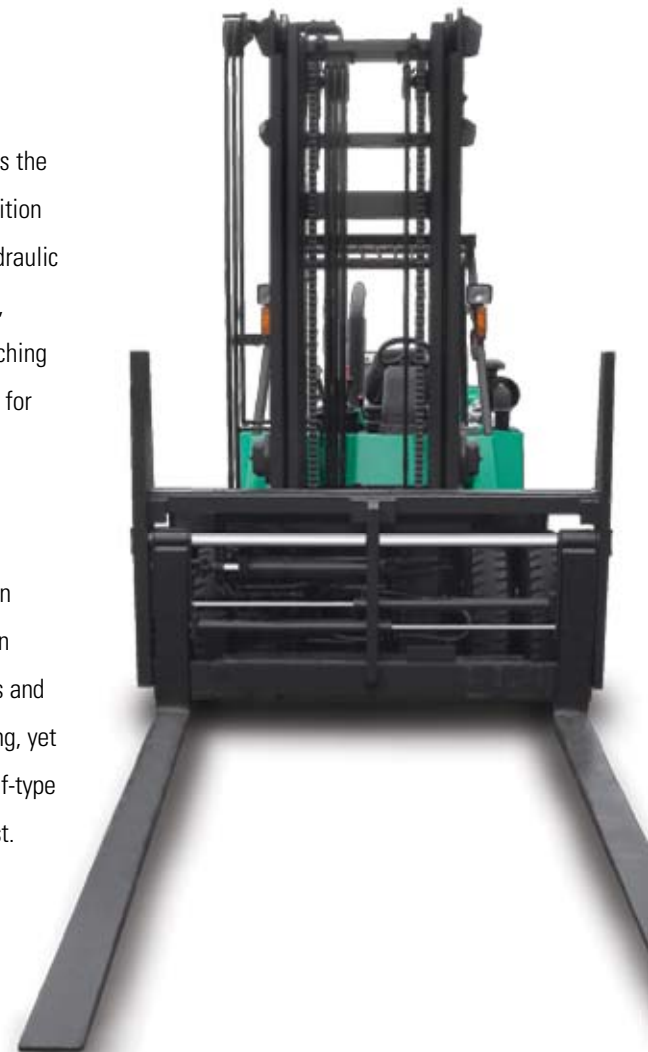

See For Yourself

- While you are sitting in the operator's compartment, you will notice the easy entry and exit, adjustable steer column, full suspension seat and spacious floor area. In addition, the visibility is maximized through the smart mast design. Flanges are narrow and webbing is deep to increase visibility.
- This truck features a Mitsubishi S6S-T diesel engine. Field tested and proven through years of use, history has shown that this is one of the most durable and reliable engines in the industry.
- The quality design of the engine is simple, fuel efficient and as a result of a unique "pre-combustion chamber", more powerful and quiet than other competitive diesel engines.
- Not only is the FD70E powerful, but the two-speed power shift transmission is versatile. Because no application is the same, you have the option of automatic shifting or toggling to a single-speed transmission. This allows you to control the top travel speed, eliminates excessive shifting for short shuttles and provides more torque at low speeds.



Ready. Reliable. Right On The Money.

Manufactured with superior quality and exceptional value, Mitsubishi forklift trucks are supported by a reliable dealer and field support network. Dealer locations exist throughout North and South America, offering flexible financing options and product support.

Value And Support For The Long Haul

Our programs deliver value just like our forklifts. One example is our parts program, designed to be your single source for quality replacement parts — no matter what forklift brand you own. Another is the Master Protection® program which offers extended powertrain warranties for your Mitsubishi forklifts. Your local Mitsubishi forklift truck dealer offers products and services including Master Maintenance® programs, which tailor service and maintenance to your specific applications. In addition, they can provide options and additional visual and audible warning devices aimed at your specific applications and requirements. Operator training programs are also available to help reduce the potential for product damage and personal injury.

15,500 lb Capacity Diesel Pneumatic Tire Forklift Truck



1-888-MIT-LIFT
www.mit-lift.com